



# Smart Shopper™ Marketplace Scanner Installation Kit

## Kit Parts

## Installation Instructions Tool Required for installation: Phillips Screwdriver (not included).



**Scanner**



**Label**  
(Apply Last)



**Instruction Sheet**

**#8 x 1" Screw - 2**



**Shown Actual Size**

**Note:** Tighten the screws with a Phillips screwdriver. Do not over-tighten.

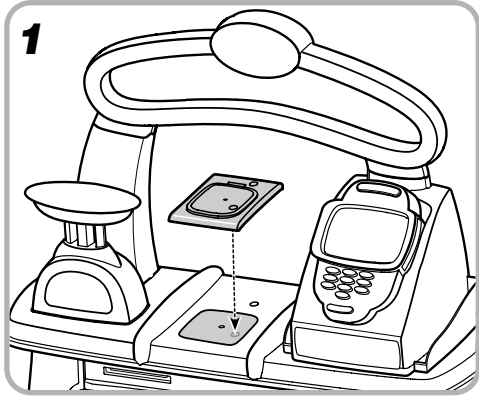

- Place the scanner on the counter top and press down firmly. The scanner should push a hole through the label on your counter top revealing a screw hole. Remove the scanner from the counter top.

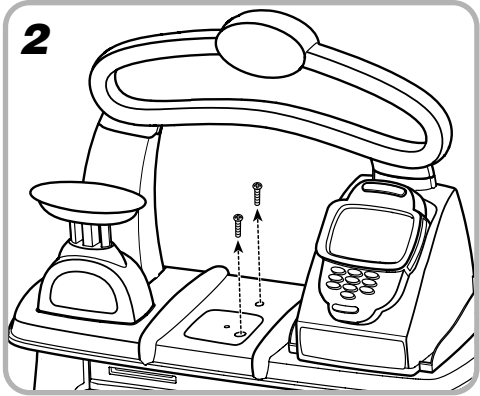

- Remove the two existing screws from your counter top. Discard these screws.

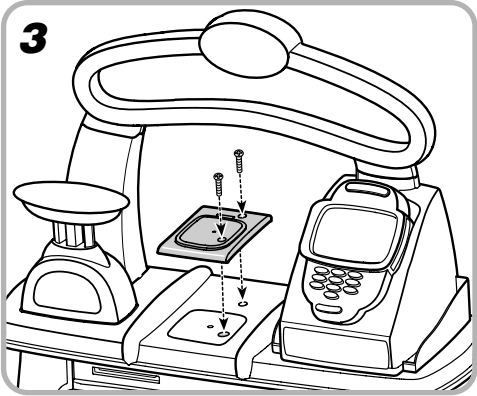

- Replace the scanner on the counter top. Insert the two enclosed screws into the holes in the scanner.

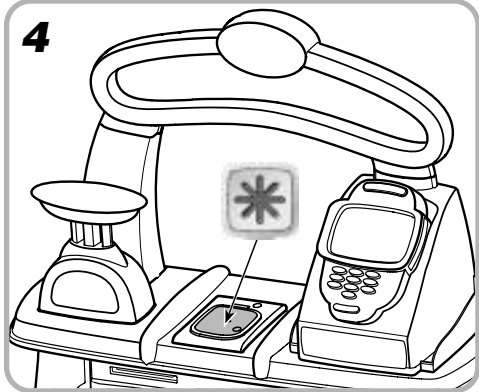

- Apply the label as shown in the illustration.

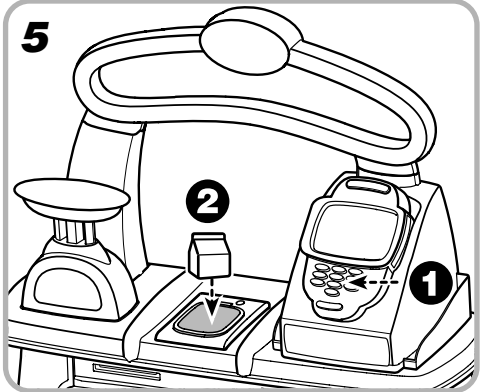

- Installation is now complete.**
- To activate the scanner sound effects, first press any key on the cash register, then place an item on the scanner and press lightly.

**Questions? We'd like to hear from you!**  
Call Fisher-Price® Consumer Relations,  
toll-free at **1-800-432-5437**.

Model Number: B1504